

## Knowles Avenue, Rhyl

Offers In Region Of £125,000

2 1 1



This two bedroom detached bungalow is situated within close proximity of the seafront and promenade and a short drive from Rhyl's main town centre with all its shops and public services. The property has the added benefit of solar panels, double glazing and off street parking, however it is need of some refurbishment and is priced accordingly.

Directions: Proceed away from the Rhyl Office onto Russell Road continue onto Rhyl Coast Road, turning left at the traffic lights onto Tynwydd Road, first right into Knowles Avenue and the property can be seen on the right hand side by way of a For Sale board.

## Key Features

- Two bedrooms
- Close to seafront and promenade
- Solar panels
- Off street parking
- Council tax C
- Detached Bungalow
- Some modernisation required
- Enclosed garden
- EPC D
- 

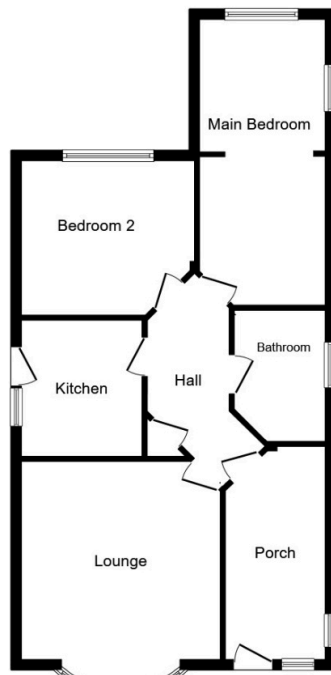

**Floor Plan**

Total floor area 70.1 sq.m. (755 sq.ft.) approx

This floor plan is for illustration purposes only and may not be representative of the property. The position and size of doors, windows and other features are approximate. Unauthorized reproduction prohibited. © PropertyBOX